

ORDINANCE NO. 2015-19

AN ORDINANCE AMENDING ORDINANCE NO. 2005-24 TO REZONE APPROXIMATELY 2.9 ACRES (**Z15-08 2103 AUSTIN STREET**) FROM "OS" (OPEN SPACE) TO "RSF-20" (SINGLE FAMILY RESIDENTIAL WITH A MINIMUM LOT SIZE OF 20,000 SQUARE FEET), LEGALLY DESCRIBED AS A PORTION OF LOT 29 (29-2) DIVISION C LEAGUE CITY. AND HAWAII AVENUE BETWEEN OLIVE STREET AND PEACH STREET, GENERALLY LOCATED SOUTH OF AUSTIN STREET, EAST OF TEXAS AVENUE AND WEST OF SOUTH EGRET BAY BOULEVARD (FM 270), WITH THE APPROXIMATE ADDRESS BEING 2103 AUSTIN STREET IN THE CITY OF LEAGUE CITY, TEXAS

WHEREAS, at the May 1, 1999 General Election the qualified voters of the City of League City voted that staff proceed with the concept of zoning for the City; and

WHEREAS, on August 10, 1999, the City Council of the City of League City, Texas (the "Council") adopted Ordinance No. 99-52 amending the Code of Ordinances of the City of League City to add Chapter 125 regarding zoning; and

WHEREAS, on August 30, 2005, the City Council adopted Ordinance No. 2005-24 amending Chapter 125 of the Code of Ordinances of the City of League City and adopting zoning ordinances consistent with the Comprehensive Plan for the City of League City, Texas; and

WHEREAS, Chapter 125, Section 125-49 of the Code of Ordinances establishes a procedure for a property owner, his authorized agent, or the City Planner to request zoning changes; and

WHEREAS, the City Council deems it necessary and in the best interest of the citizens to rezone approximately 2.9 acres from "OS" (Open Space) to "RSF-20" (Single Family Residential with a minimum lot size of 20,000 square feet), legally described as a portion of Lot 29 (29-2) Division C League City, generally located south of Austin Street, east of Texas Avenue and west of South Egret Bay Boulevard (FM 270) as shown in the attached Zoning / Notification Map in Exhibit "A" and as depicted in the Survey as a 2.8440 acre tract of land out of a part of Lot 29, of Division "C" of League City, located in the M. Muldoon Two League Grant, Abstract No. 18, Galveston County, Texas.

NOW, THEREFORE, BE IT ORDERED BY THE CITY COUNCIL OF THE CITY OF LEAGUE CITY, TEXAS, that:

Section 1. The facts and opinions in the preamble of this ordinance are true and correct.

Section 2. The approximate 2.9 acres, legally described as a portion of Lot 29 (29-2) Division C League City, generally located south of Austin Street, east of Texas Avenue and west South Egret Bay Boulevard (FM 270), as shown in the attached Zoning / Notification Map in Exhibit "A" and as depicted in the Survey as a 2.8440 acre tract of land out of a part of lot 29, of Division "C" of League City, located in the M. Muldoon Two League Grant, Abstract No. 18, Galveston County, Texas, shall heretofore be zoned "RSF-20" (Single Family Residential with a minimum lot size of 20,000 square feet).

Section 3. All ordinances and agreements and parts of ordinances and agreements in conflict herewith are hereby repealed to the extent of the conflict only.

PASSED on first reading the 23rd day of June, 2015.

PASSED on second reading the 14th day of July, 2015.

PASSED AND ADOPTED on the 14th day of July, 2015.

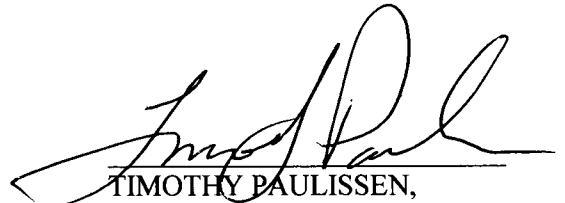
  
TIMOTHY PAULISSEN,  
Mayor

ATTEST:

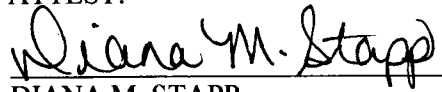
  
DIANA M. STAPP,  
City Secretary

APPROVED AS TO FORM:

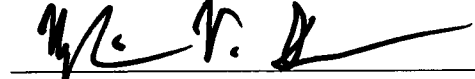
  
NGHIEM V. DOAN  
City Attorney

AUSTIN STREET (WIDTH VARIES)

10' RESERVED FOR  
RIGHT OF WAY WIDENING

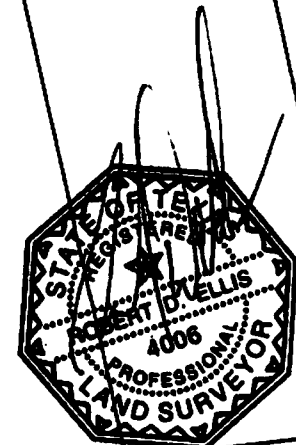
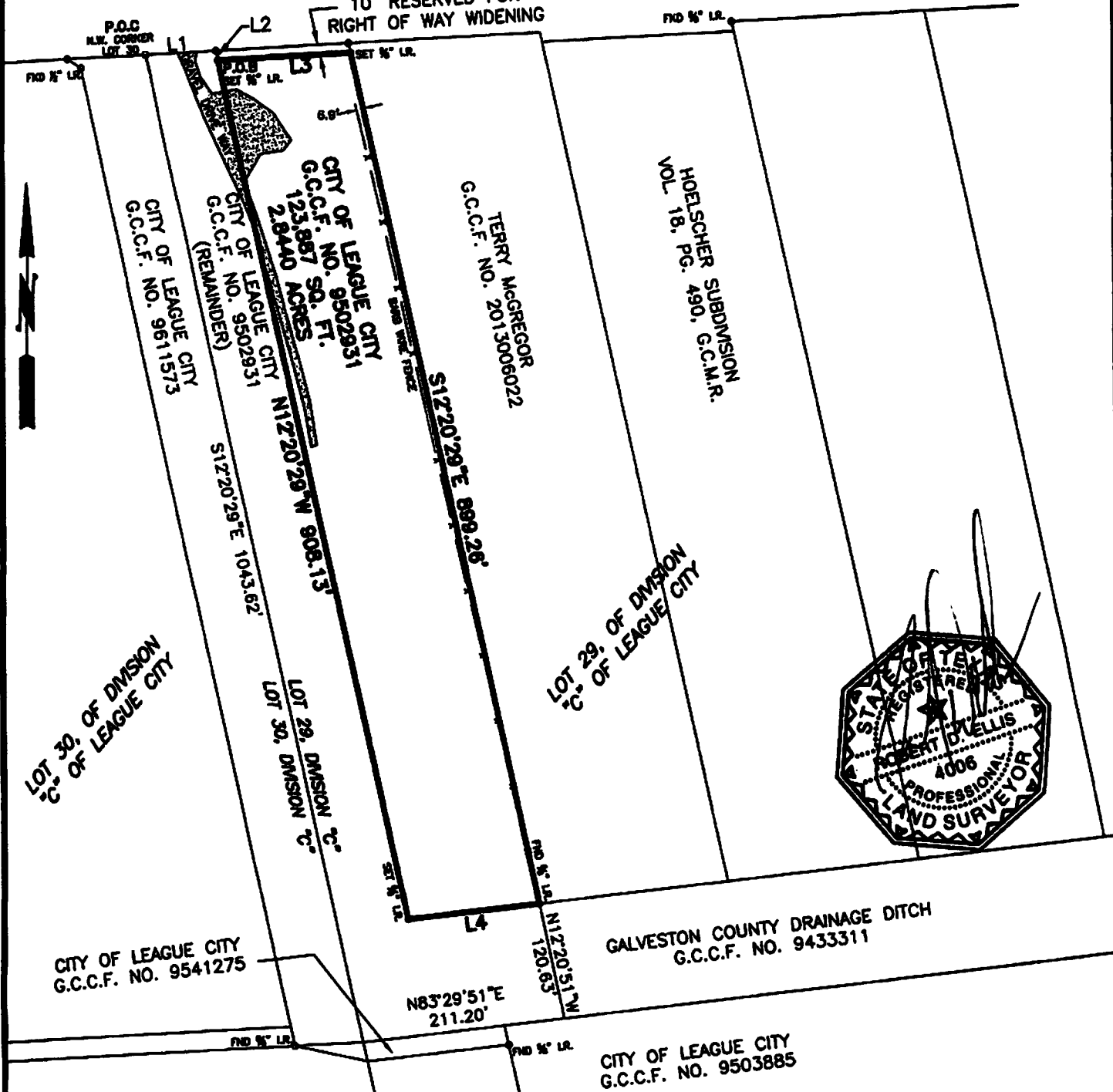

LINE	BEARING	DISTANCE
L1	N 87°08'17" E	74.01'
L2	S 12°20'29" E	10.14'
L3	N 87°08'17" E	138.99'
L4	S 83°29'51" W	137.80'

**NOTES:**

- 1) All corners set with 5/8" iron rods, stamped RD ELLIS RPLS 4006 unless otherwise noted.
  - 2) Basis of Bearing: Grid North Texas State Plane Coordinate System, NAD83, South Central Zone
- PROJECT NO. 2214

**ELLIS SURVEYING SERVICES**

8419 Emmett F. Lowry Texas City, Texas 77591  
Tel.: 409-938-8700 Fax: 866-678-7685  
Registration No 100340-00

**EXHIBIT "A"**

A 2.8760 ACRE TRACT OF LAND  
OUT OF AND A PART OF  
LOT 29, OF DIVISION "C" OF LEAGUE  
CITY, LOCATED IN THE M. MULDOON  
TWO LEAGUE GRANT, ABSTRACT NO. 18,  
CITY OF LEAGUE CITY,  
GALVESTON COUNTY, TEXAS  
09-11-13

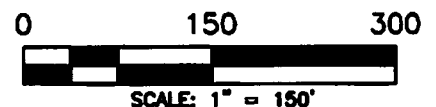











500' Notification Buffer

Subject Property

EGRET BAY

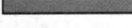
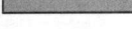
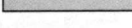
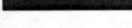
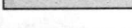
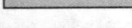
HEWITT

-  Planned Unit Development
-  Residential Single Family 20
-  Residential Single Family 10
-  Residential Single Family 7
-  Residential Single Family 5
-  Residential Multi-Family 1.2
-  Neighborhood Commercial
-  General Commercial
-  Office Commercial
-  Mixed Use Commercial
-  Limited Industrial
-  Public and Semi-Public
-  Open Space

**Zoning Map**  
City of League City  
Department of Planning & Development  
For Planning Purposes Only

1 inch equals 298 feet

